

HG2 INSTALLATION GUIDE

Tahoe, Yukon & Suburban 2015-2020
Rear Z-Drive® Step Pad Bumper



STEP 1:

Start by taping off the surrounding edges of the vehicle and gathering any tools you may need.

Remove the factory bumper by inserting a Phillips head screwdriver into each

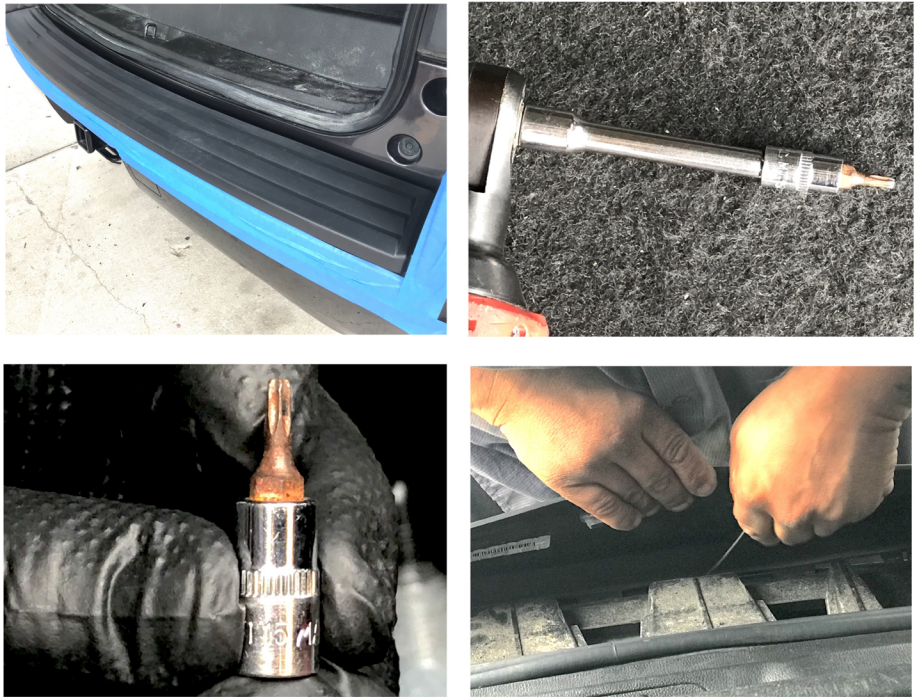

STEP 2:

Unfurl the wire from the bumper pad and feed the wire from the left side to the center of the bumper pad.

Remove red tape, insert HG2 Bumper and apply pressure on each side.



NOTE:

DO NOT APPLY PRESSURE DIRECTLY ON THE OPTICS.

Use the gaps between the optics to apply pressure for the install.

Sitting or standing on the Aftermarket Step Pad can cause damage to the lenses and optics

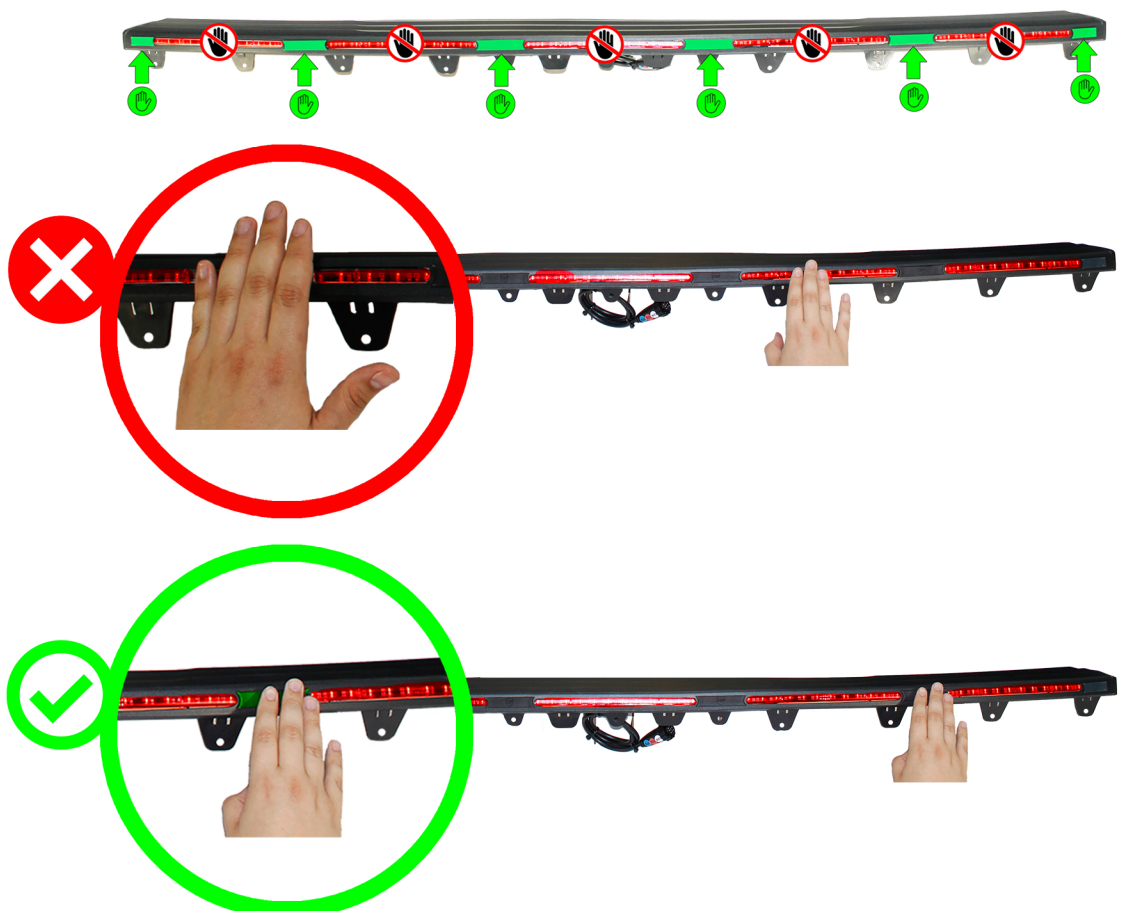

WIRING DIAGRAM

Chassis Ground: Connect to a scraped (bare) metal surface in the driver kick panel. NEVER connect to dash brackets or at the same point as other components.

12v Constant Power: Remove the in-line fuse before connecting to a wire that has (+)12v at all times.

Switch On/Off: Powers the unit on and off.

Scene Lighting: White lights will stay on to illuminate an entire scene.

Cruise Mode: White takedown lights will stay on without flashing.

Momentary Pattern: Pattern will only engage while the switch is pressed.

Right Directional: Controls the right directional signal.

Left Directional: Controls the left directional signal.

BLACK (-) Chassis Ground

RED (+) 12V Constant Power

WHITE (+) Switched Power

BROWN (+) Takedown Power

GREEN (+) Cruise Mode

BLUE (+) Momentary Pattern

YELLOW (+) Right Directional

ORANGE (+) Left Directional



THANK

YOU



If you have any questions or concerns,
please reach out to us at 866.468.4569.

THANK YOU.