

HG2 ROUND INTERIOR DOME LIGHT

INSTALLATION REFERENCE GRAPH

*Details subject to change, measure with the light unit first!

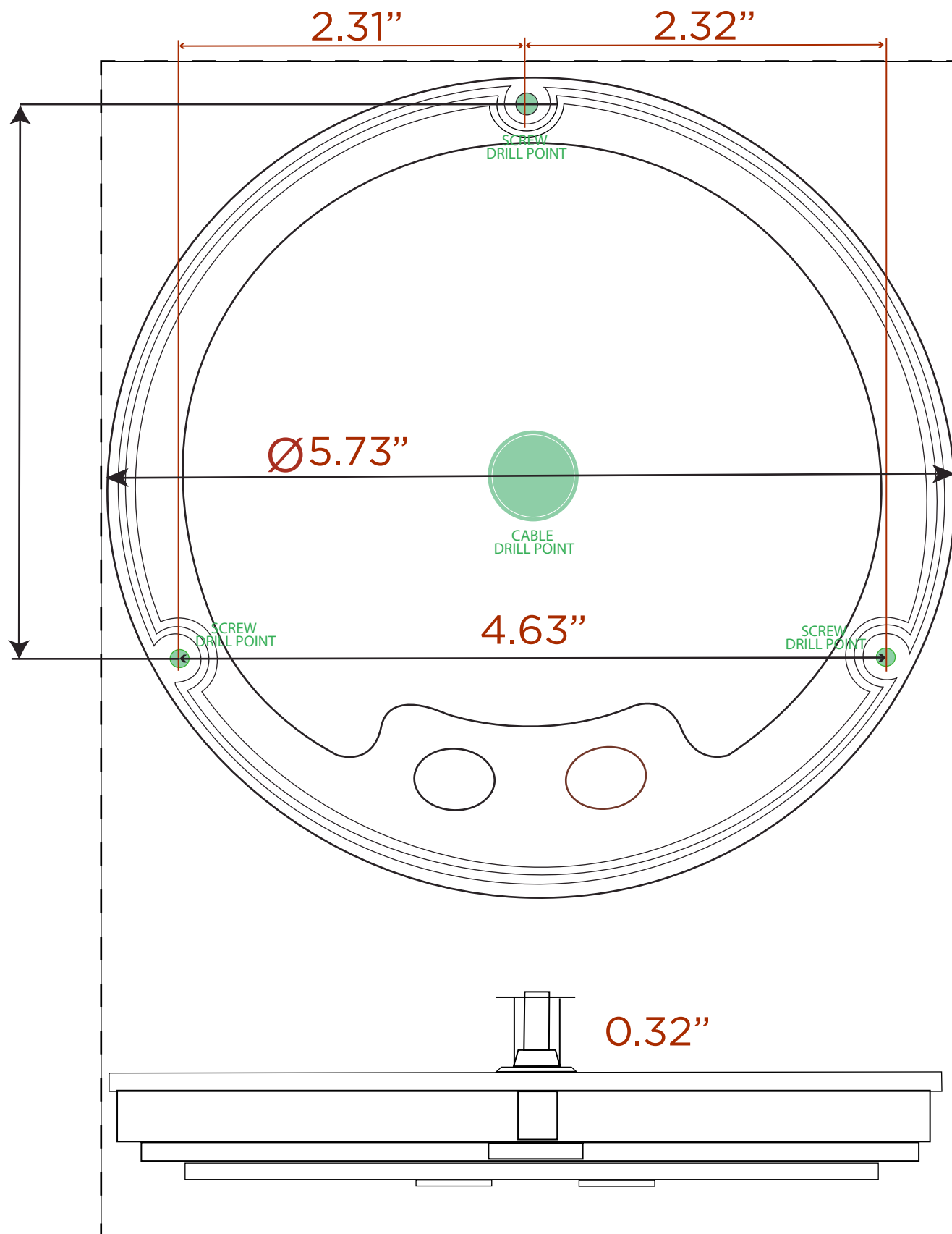

WARNING

- The installer is required to have a good understanding of automotive electronics & systems.
- The wiring pin-out must be strictly followed whether the installer wishes to add their own outboard switch or not. Any fault or damage resulting from wiring error will not be responsibility of the manufacturer.
- When drilling holes for mounting this product, use every means to make sure to avoid damage to the vehicle's vital components
- Make sure the holes created/utlized by this product are airtight and watertight.
- Do not install this product or route any wires in the deployment area of the vehicle's airbags.
- Make sure the vehicle's main power is turned off when installation is in the process.
- All customer-supplied wires that connect to the positive (+) terminal of the battery must be sized to supply at least 125% of the maximum operating current and they must be fused at the battery.
- Do not attempt to activate or control this device in a hazardous driving situation.
- Do not stare directly into the light, lest momentary eye damage occurs.
- Do not use harsh detergents and chemicals to clean the device.
- Failure to follow these instructions will void the products warranty, and the manufacturer will not cover serious damage and/or injury that result from misuse!

INSTALLATION GUIDE

1. Mark and pre-drill holes on the designated surface to contain the screws.
2. Use the included screws to mount the light through the holes.
3. Solder the tips of the +VDC & -GND wires to the power lines for connection, according to the correct polarity.
4. Clip on the bezel according to the correct orientations.

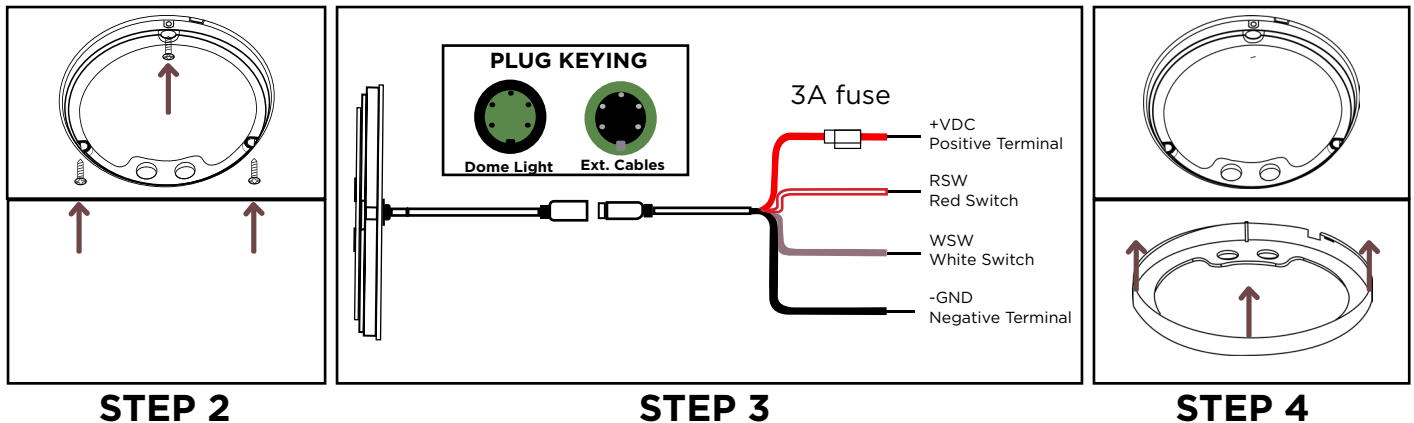

USE GUIDE - ONBOARD SWITCH & OUTBOARD SWITCH

- Press the red button to turn the red lights on or off. Press the white button to turn the white lights on or off
- When in single color mode (red or white), press and hold the button for the active color to adjust the brightness up or down
- When in dual color mode (red + white) press and hold either button to adjust the brightness up or down
- In the above two modes, the lights will flash once to indicate brightness at its maximum/minimum
- When the red/white LEDs are turned off, press and hold either button to turn the indicator on or off

OUTBOARD SWITCH WIRING GUIDE

For custom outboard switches, the installer should be aware of their wire signaling. For the Red Switch (RSW) and White Switch (WSW) wires, use **MOMENTARY SWITCHES** that connect them to the +VDC wire when in contact. In this wiring, **press** the switches to turn their respective color LED **on or off**

